

## Specifications

Insulation Resistance: 1,000MΩ min. at 500V DC  
 Dielectric Withstanding Voltage: 700V AC for 1 minute  
 Contact Resistance: 30mΩ max. at 10mA/20mV max.  
 Operating Temperature Range: -40°C to +150°C (type PSF)  
 -55°C to +170°C (type PES & PEI)  
 Mating Cycles: 10,000 insertions min.

## Materials and Finish

Housing: Polysulphone (PSF), glass-filled  
 Polyethersulphone (PES), glass- filled  
 Polyetherimide (PEI), glass-filled  
 Contacts: Beryllium Copper (BeCu)  
 Plating: Gold over Nickel

## Part Number (Details)

IC51 - 020 2 - 347 - MF

Series No.	IC51
No. of Contact Pins	020
No. of Sides with Contacts	2
Design Number	347
MF = Flanged Unmarked = Not Flanged	MF

Typical Example of a SOP Socket  
 (for individual PCB-Layouts refer to dimension tables)

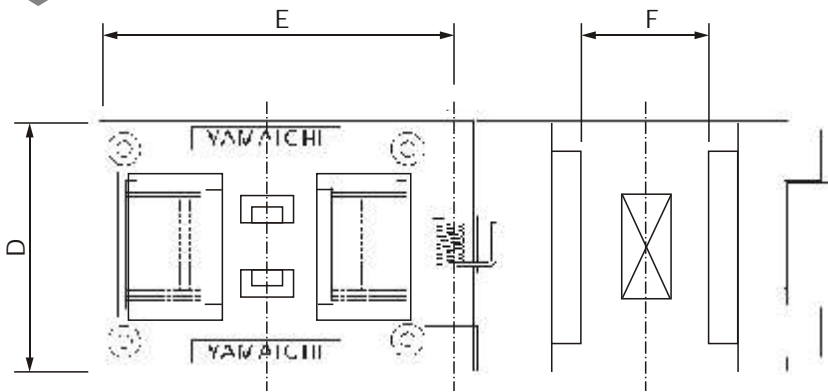

## Outline IC Dimensions

A = Body width (max.)  
 B = Also the lid size for IC  
 C = Tip-to-Tip  
 F = Lid size from Socket

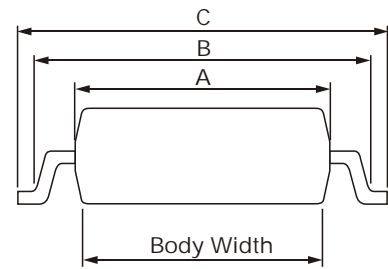

### Note:

Sockets with ( S ) "Separator" can accept and properly align lower pin count devices.  
 Sockets with ( FB ) "Floating Base" will only accept devices with the same pin count as the socket.

## SOP Clamshell

Part Number	Pin Count	Pitch (mm)	Matching IC Dim.				Note	Socket Dimensions		
			Body Width	A (max)	B (max)	C (nom.)		D	E	F
IC51-0202-714	20	1.27	7.6	7.6	9.3	10.3	FB	18.0	32.0	9.3
IC51-0202-347	20	1.27	7.7	7.7	9.5	10.3	S	16.0	31.5	9.53
IC51-0202-932-1	20	1.27	5.4	5.5	6.5	7.2	S	15.5	26.0	7.2
IC51-0202-1026	20	1.27	5.2	5.25	7.2	7.9	FB	18.5	32.5	7.2
IC51-0222-803	22	1.27	5.5	5.5	6.0	6.6	S	16.5	29.0	6.6
IC51-0242-308	24	0.80	5.4	5.4	6.2	7.2	FB	32.0	38.9	7.2
IC51-0242-577	24	0.80	7.8	7.85	9.3	10.0	S	22.0	32.5	9.3
IC51-0242-310-1	24	1.00	4.5	4.55	5.2	6.0	S	18.0	28.5	5.2
IC51-0242-303-1	24	1.27	5.3	5.35	7.3	8.0	S	18.0	28.5	7.3
IC51-0242-303-3	24	1.27	5.35	5.4	6.0	7.0	S	18.0	30.5	7.00
IC51-334-1.KS-6411	24	1.27	7.5	7.6	9.4	10.3	S	22.0	32.5	9.4
IC51-0242-793	24	1.27	5.5	5.5	7.1	8.0	S	18.5	29.0	7.15
IC51-0242-367-1	24	1.27	9.4	9.4	10.43	11.2	S	18.0	32.5	10.43
IC51-0242-980	24	1.27	5.2	5.25	7.2	7.9	FB	18.5	32.5	7.2

# IC51 - Clamshell

# Small Outline Package (SOP)

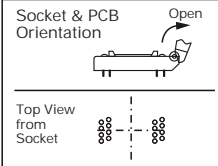

## Recommended PCB Layouts (20 to 24 pins)

20 pins (SOP)

IC51-0202-714

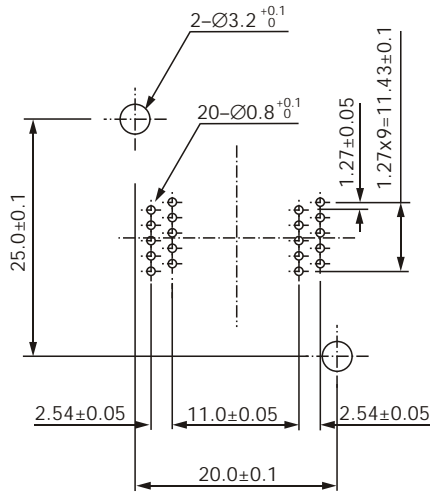

20 pins (SOP)

IC51-0202-347

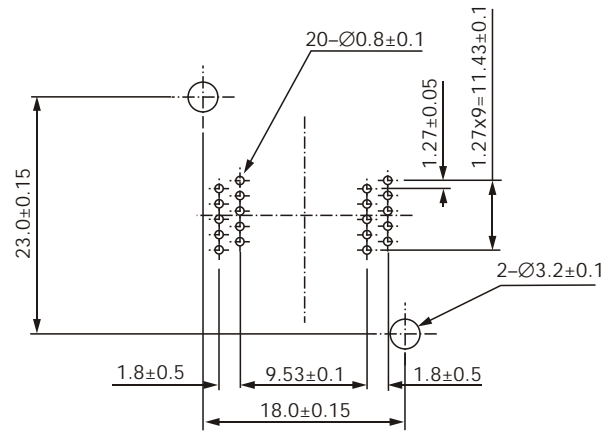

20 pins (SOP)

IC51-0202-1026

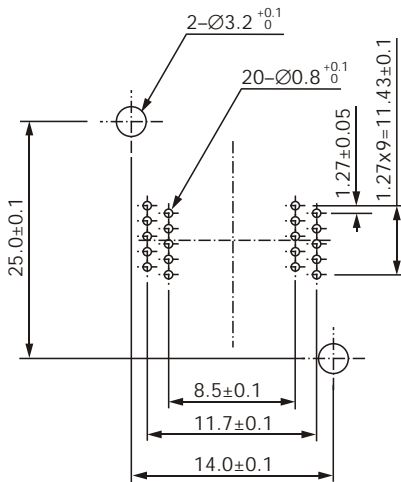

22 pins (SOP)

IC51-0222-803

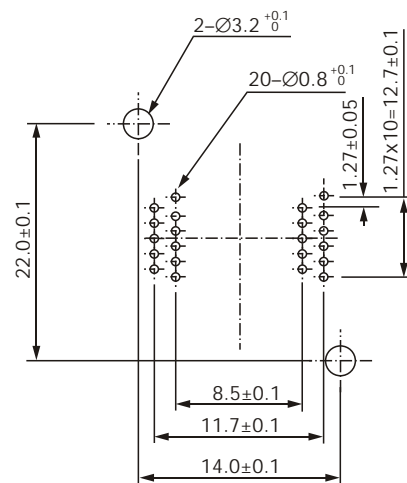

20 pins (SOP)

IC51-0202-932-1

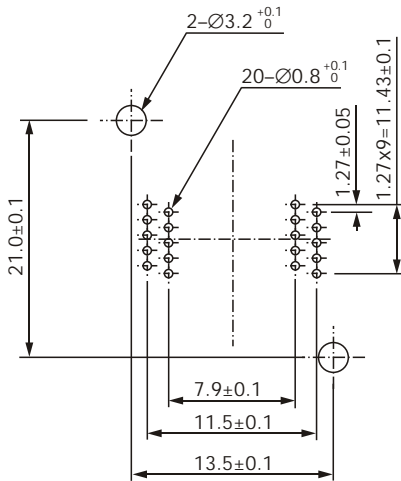

24 pins (SOP)

IC51-0242-308

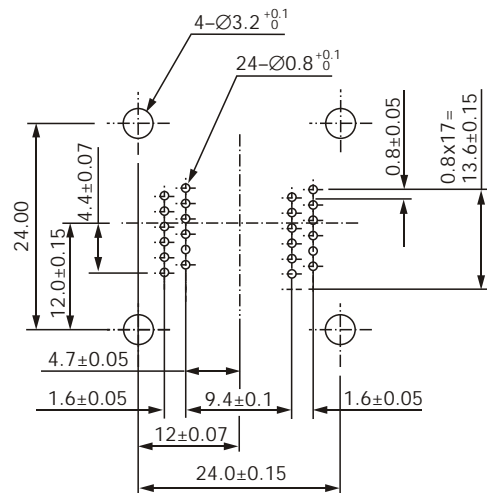

# IC51 - Clamshell

# Small Outline Package (SOP)

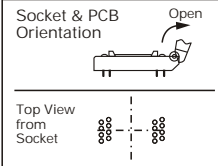

## Recommended PCB Layouts (14 to 16 pins)

24 pins (SOP) IC51-0242-310-1

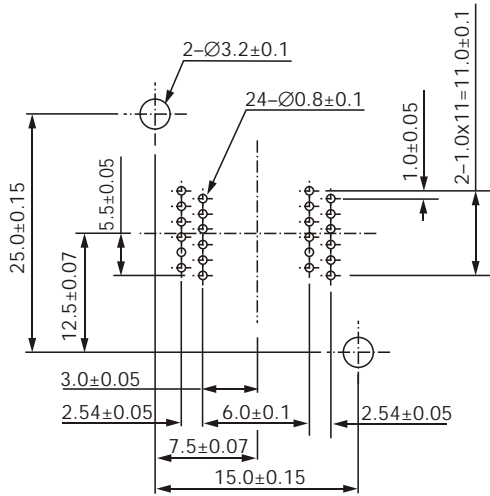

24 pins (SOP) IC51-0242-793

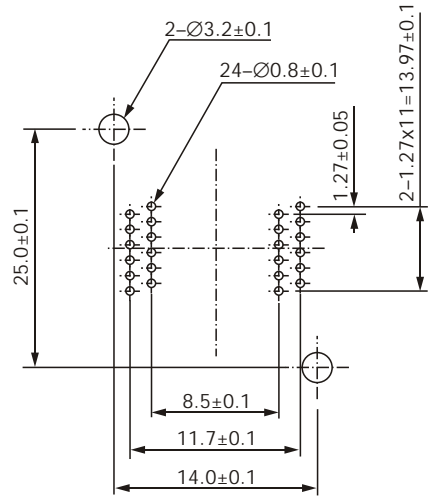

24 pins (SOP) IC51-0242-303-1  
IC51-0242-303-3

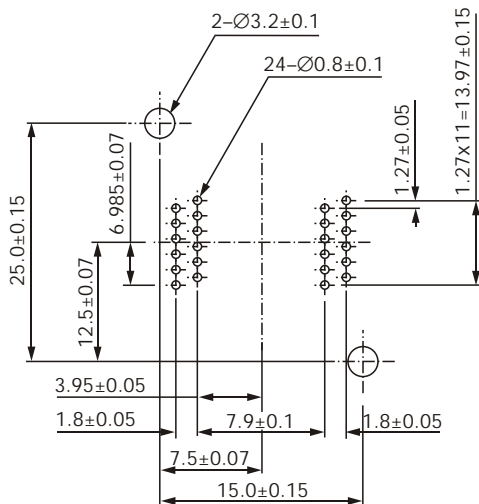

24 pins (SOP) IC51-0242-577

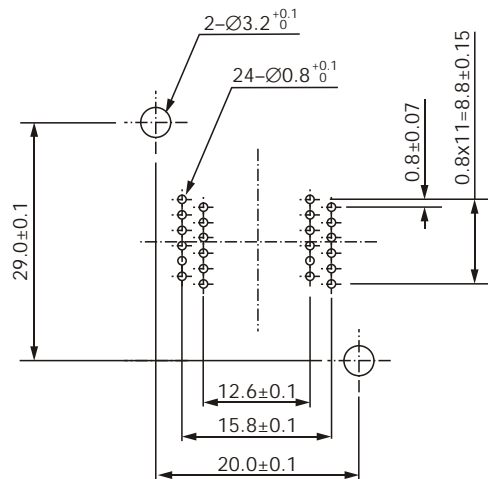

24 pins (SOP) IC51-334-1.KS6411

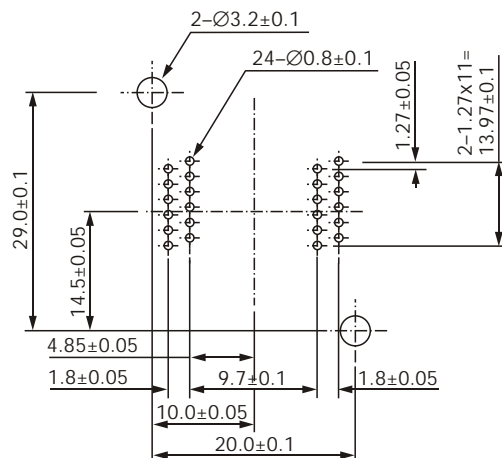

24 pins (SOP) IC51-0242-367-1

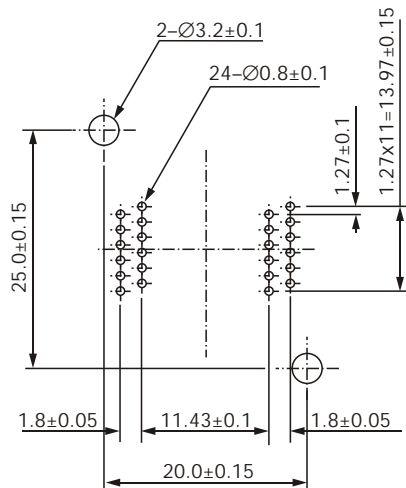

# IC51 - Clamshell

# Small Outline Package (SOP)

Socket & PCB Orientation

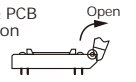

Top View from Socket



## Recommended PCB Layouts (24 pins)

24 pins (SOP)

IC51-0242-980

