

Aoyue[®] 388 CircuitVise
Pronunciation: /aw u/

Instruction Manual

Please read entire manual before using unit.
Keep manual accessible for future reference.

www.aoyue3d.com

This manual is designed to familiarize and guide the user with proper operation and maintenance of the equipment. Please read carefully and observe the guidelines in order to avoid risk of injury and accidents.

TABLE OF CONTENTS

Description	3
Functions and Features	4
Package Inclusions	4
Assembly of Platform.....	5-8

PRODUCT DESCRIPTION

The Aoyue 388 CircuitVise is an extremely versatile tool for keeping electronic components and circuit boards steady while soldering. One of the number one causes of poorly-formed and unreliable solder joints is movement while solder is still in its molten state. To remedy this, the durable metal surface of the 388 comes equipped with two fully-articulating helping hand clamps and 4 powerful magnetic PCB holders that can accommodate a variety of PCB sizes.

The 388 platform is designed to accept two additional helping hands clamps (sold separately) for even greater flexibility and holding power. There are connection points at each corner of the platform to attach up to four helping hand clamps. A screw and lock washer system is employed to ensure arms stay in place while positioning and soldering. Since the entire 388 work surface is metal, it can also be used with any magnetic tools currently available; further expanding its capabilities.

The rear of the 388 features a special molded slot for attaching Aoyue 486 and 486+ fume extractors to create a safer soldering environment. The slot conveniently removes the need for the extractor stand, saving precious work space with its integrated set up. The upgraded 486+ model fume extractor offers the added benefits of LED illumination and an exhaust duct to redirect fumes where the user desires.

Notes:

- 1. Fume extractor models 486 and 486+ are sold separately.**
- 2. Additional helping hand clamps can be purchased separately.**
- 3. Other magnetic tools not included, see our website for more info.**

FUNCTIONS and FEATURES

- Durable metal platform base plate
- Magnetic PCB holders (4)
- Helping hand clamps (2 with option to add up to 4)
- Fully-articulating helping hands with locking mechanism
- Molded slot for attaching Aoyue fume extractors
- Compatible with additional magnetic tools

PACKAGE INCLUSIONS

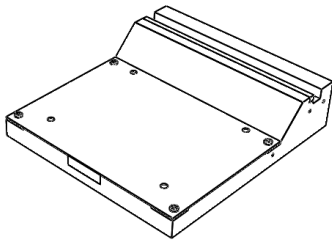

Aoyue 388 base



Helping hands and screws with spring washers and external tooth washers



Magnetic PCB holder

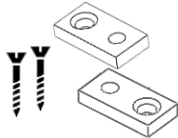

Locking screws and plastic stoppers

ASSEMBLY GUIDE

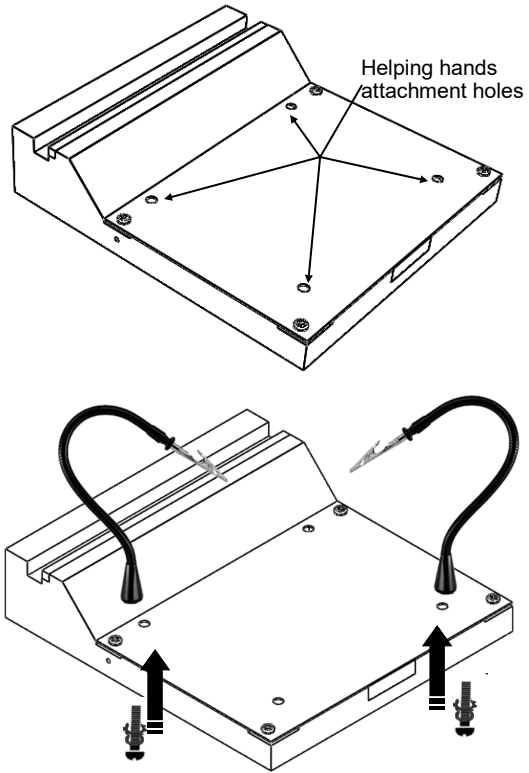

Attach helping hands in the desired position by using any of the four allotted attachment holes. Use the lock washers on the underside of the platform base.

ASSEMBLY GUIDE

To attach 486 or 486+ Smoke Absorber :

(486, 468+ sold separately)

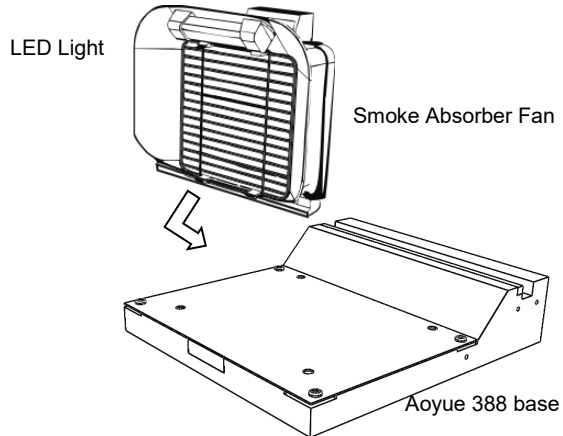

Slide the fume extractor fan into the slot provided on the top portion of the 388 base.

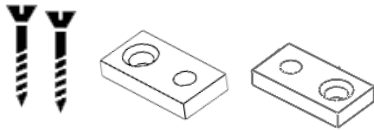

Optional step: You can lock the fan into place by using the provided locking screws and plastic stoppers.

ASSEMBLY GUIDE

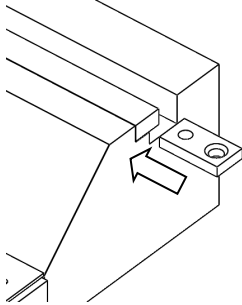

After the fan is in position, slide the plastic stoppers into the same slot on either side of the fan. Then use the screws to fix them in place.



A guide hole can be found in the slot for the screw. Screw in the plastic stopper through the hole with the counter bore.

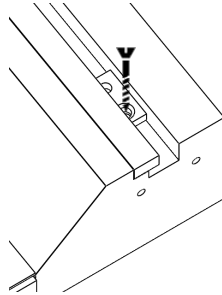

Place magnetic PCB Holder on the metal plate. The station is ready to use. With the fume extractor attachment

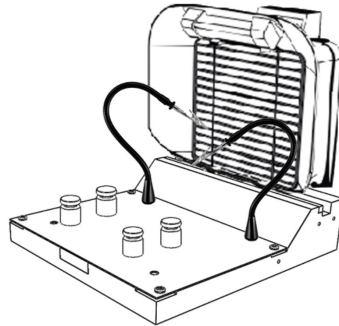

ASSEMBLY GUIDE

486+ Smoke Absorber guide : (486, 468+ sold separately)

