

Specifications

Nominal Voltage		12 V
Capacity (25°C)	20HR(10.5V)	14Ah
	10HR(10.5V)	13.5Ah
	1HR(9.60V)	9.8Ah
Dimension	Length	151±1.5mm (5.94inch)
	Width	98±1mm (3.86inch)
	Height	95±1mm (3.74inch)
	Total Height	101±1mm (3.98inch)
Approx. Weight		3.65kg (8.04lbs)±5%
Terminal type		T2/T1
Internal resistance (Fully charged, 25°C)		Approx. 19mΩ
Capacity affected by temperature (20HR)	40°C	102%
	25°C	100%
	0°C	85%
	-15°C	65%
Self-discharge (25°C)	3 month	Remaining Capacity: 91%
	6 month	Remaining Capacity: 82%
	12 month	Remaining Capacity: 65%
Nominal operating temperature		25°C±3°C(77°F±5°F)
Operating temperature range	Discharge	-15°C~50°C(5°F~122°F)
	Charge	-10°C~50°C(14°F~122°F)
	Storage	-20°C~50°C(-4°F~122°F)
Float charging voltage(25°C)	13.60 to 13.80V Temperature compensation: -18mV/°C	
Cyclic charging voltage(25°C)	14.50 to 14.90V Temperature compensation: -30mV/°C	
Maximum charging current	3.5A	
Terminal material	Copper	
Maximum discharge current	180A(5 sec.)	
Designed floating life(20°C)	5 years	

- ◆ Absorbent glass mat technology;
- ◆ Recognized by CE;
- ◆ ABS container.



Dimensions

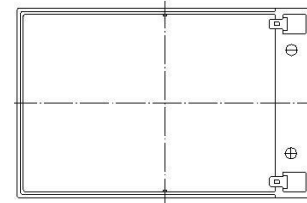
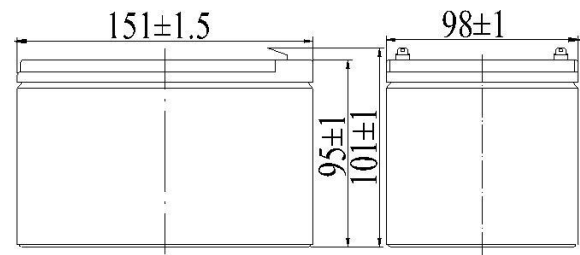

Terminal

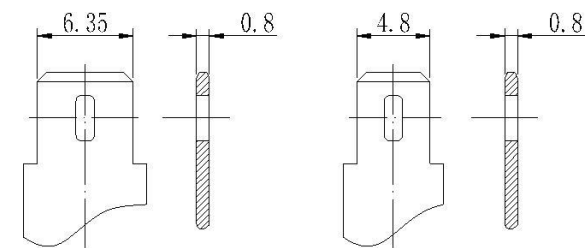

Terminal T2

Terminal T1

Constant Current Discharge Characteristics (A, 25°C)

F.V/TIME	10min	15min	30min	60min	2h	3h	4h	5h	8h	10h	20h
9.60V	34.0	26.5	14.7	8.80	4.83	3.36	2.60	2.28	1.52	1.35	0.73
9.90V	32.9	26.3	14.5	8.78	4.81	3.34	2.59	2.27	1.51	1.34	0.72
10.2V	31.5	25.2	14.1	8.76	4.78	3.32	2.57	2.25	1.43	1.33	0.71
10.5V	30.0	24.7	13.8	8.72	4.72	3.30	2.55	2.24	1.42	1.32	0.70
10.8V	29.5	23.2	13.4	8.60	4.55	3.18	2.47	2.04	1.38	1.28	0.68

Constant Power Discharge Characteristics (Watt, 25°C)

F.V/TIME	10min	15min	30min	60min	2h	3h	4h	5h	8h	10h	20h
9.60V	375	300	166	100.3	58.9	40.4	33.2	28.8	18.6	15.6	8.31
9.90V	365	294	163	99.0	58.6	40.1	33.0	28.7	18.4	15.5	8.28
10.2V	342	284	158	96.7	58.1	39.9	32.8	28.5	18.2	15.5	8.24
10.5V	320	276	155	95.0	57.4	39.6	32.4	28.4	18.0	15.4	8.20
10.8V	313	254	150	92.4	57.2	38.6	31.7	27.6	17.5	15.1	8.06

Note: The above characteristics data can be obtained within three charge/discharge cycles.

Discharge Characteristics(25°C)

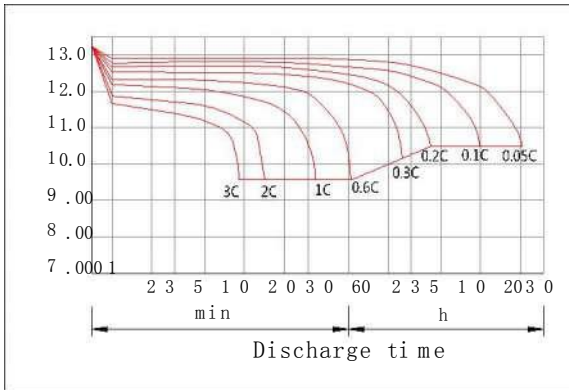

Charging Characteristics(25°C)

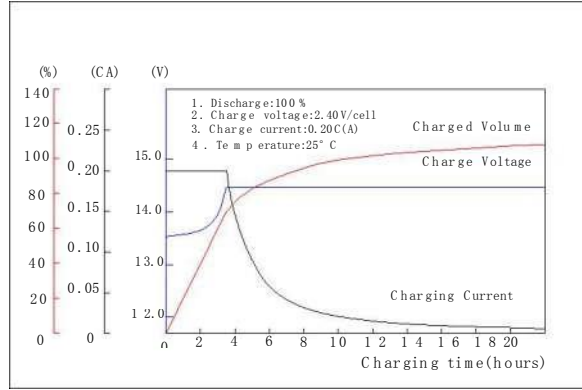

Effect of Temperature on Capacity

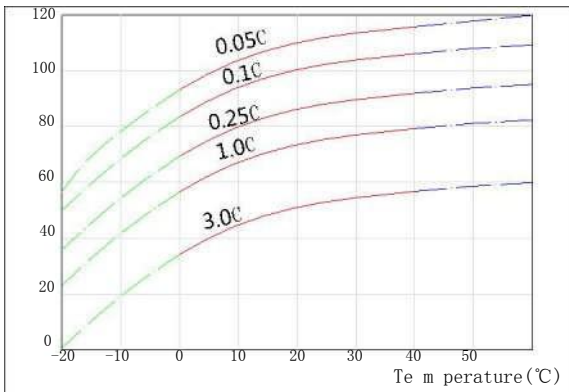

Self-discharge Characteristics

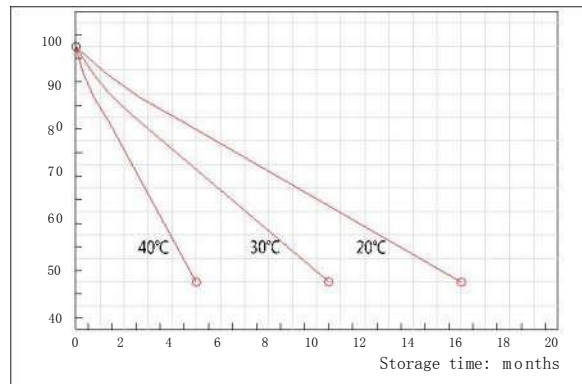

The Relationship for Open Circuit Voltage and Residual Capacity (25°C)

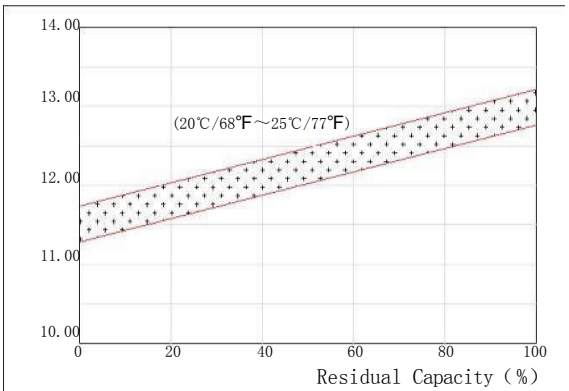

The Relationship for Charging Voltage and Temperature

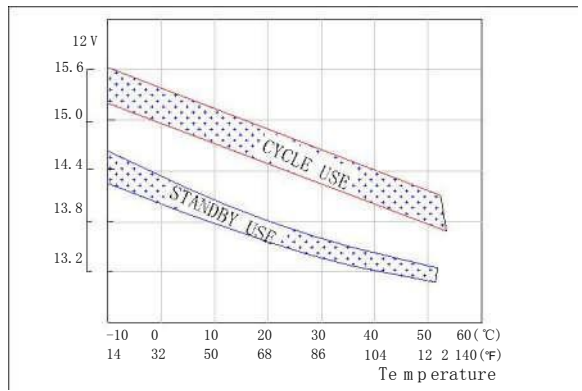

Floating Life on Temperature

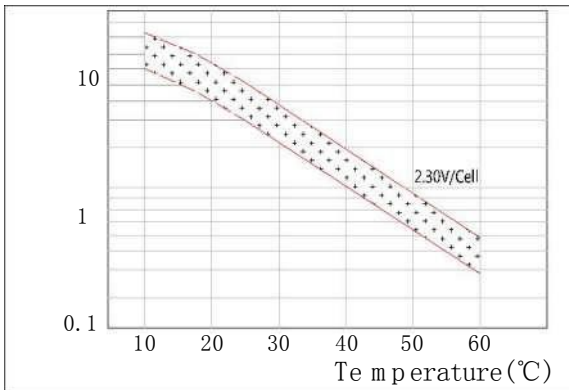

Cycle Life on D.O.D(25°C)

