

Printer model	XP-450B
Resolution	8 dots/mm(203DPI)
Printing method	Direct Thermal
Max .print speed	127 mm (5")/S
Max .print width	108 mm (4.25")
Max .print length	2286 mm (90")
Media type	Continuous, gap, black mark, fan-fold and punched hole
Media width	20-112mm (0.78"-4.4")
Media thickness	0.06 ~ 0.16 mm (2.36 ~ 6.3mil)
Label length	10 ~ 2,286 mm (0.4" ~ 90")
Label roll capacity	127 mm (5") OD (outside wound)
Enclosure	Double-walled plastic
Physical dimension	240 mm (W) x 212 mm (H) x 169 mm (D)
Weight	1.62kg
Processor	32-bit RISC CPU
Memory	4MB Flash Memory 8MB SDRAM SD card reader for Flash memory expansion, up to 4 GB
Interface	USB 2.0
Power	External universal switching power supply Input: AC 100-240V, 2.5A, 50-60Hz Output: DC 24V, 2.5A, 60W
Operation switch, button, LED	1 power switch, 1 feed button & 1 LED (3 colors: red, purple & blue)
Sensors	Black mark reflective sensor (position adjustable) Head open sensor Transmissive gap sensor
Internal fonts	8 alpha-numeric bitmap fonts Windows fonts are downloadable from software.
Barcode	1D bar code: Code 39, Code 93, Code 128UCC, Code 128 subsets A, B, C, Codabar, Interleaved 2 of 5, EAN-8,EAN-13, EAN-128, UPC-A, UPC-E, EAN and UPC 2(5) digits add-on, MSI, PLESSEY, POSTNET, China POST 2D bar code: PDF-417, Maxicode, DataMatrix, QR code
Font and barcode rotation	0°, 90° · 180° · 270°
Printer language	TSPL(EPL · ZPL · DPL)
Environment condition	Operation: 5 ~ 40°C, 25 ~ 85% non-condensing Storage: -40 ~ 60°C, 10 ~ 90% non-condensing
Safety regulation	FCC · CE · CCC · CB
Environmental concern	RoHS
Accessories	①Windows labeling software, driver and user manual CD ②quick start guide ③USB cable ④power cord ⑤external switching power adapter ⑥label spindle, fixing tab x 2
Factory options	① Real time clock ② Peel-off module
User options	① external roll mount (1"core) ② external roll mount board

A

Can remove the print head

Japan imported printing head, print life more than 40 km, about 200,000 pcs express sheet. Detachable print head design, easy to disassemble, can be replaced directly, no need whole printer maintenance back to the factory

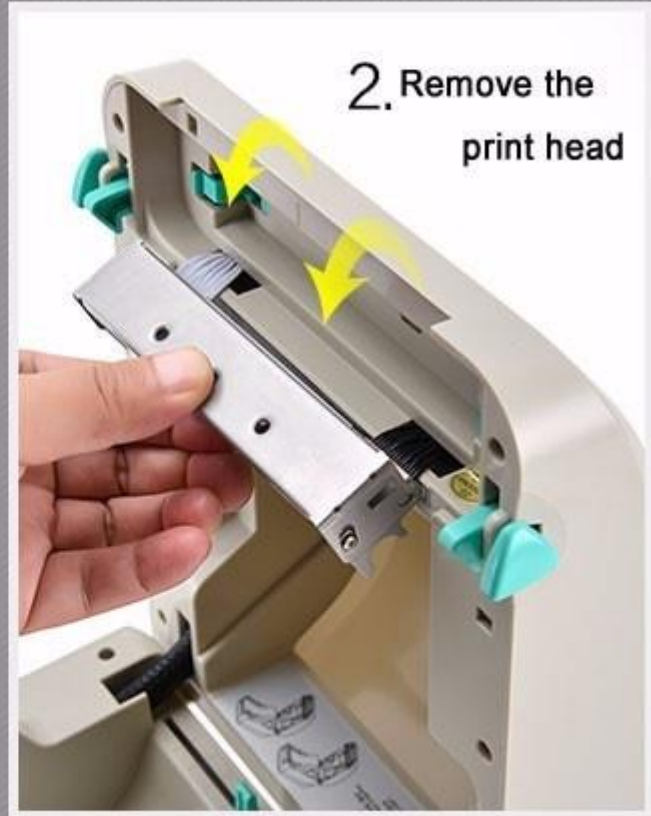

B

Removable roller

The service life of the printer roller is 200km, about 1 million express sheet
Removable roller is convenient and simple, can be replaced directly,
no need whole printer maintenance back to the factory

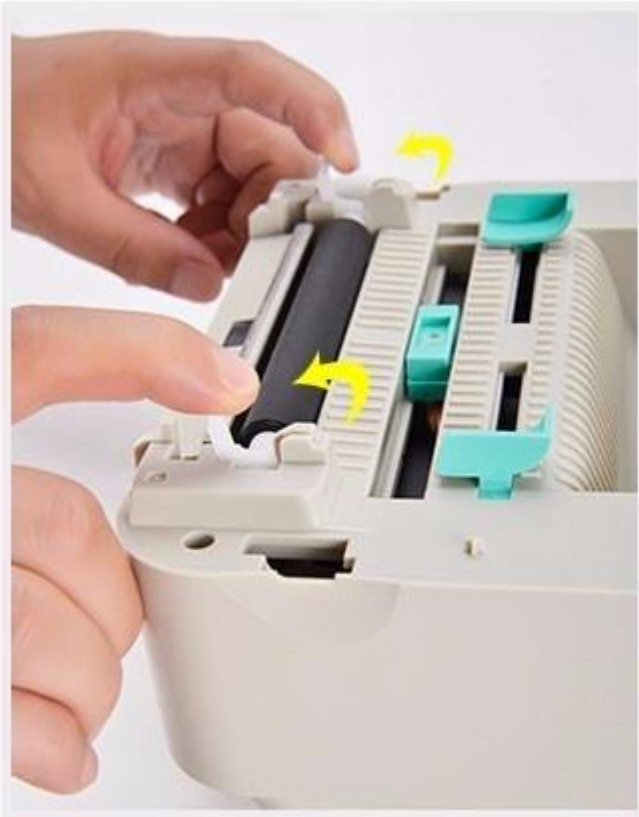



Print 20mm-108mm thermal label paper

Can print 20-108mm width label paper. Meet customers' different printing requirements

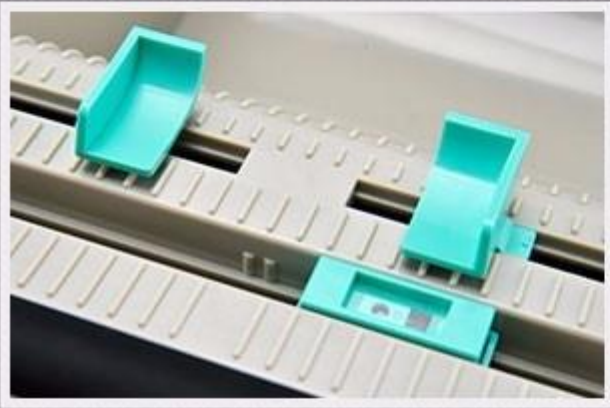

Printing width can be adjustable within 20-108mm

