



5.0 mm DIA LED LAMP

L-5T47UWC

REV:A / 0

PACKAGE DIMENSIONS

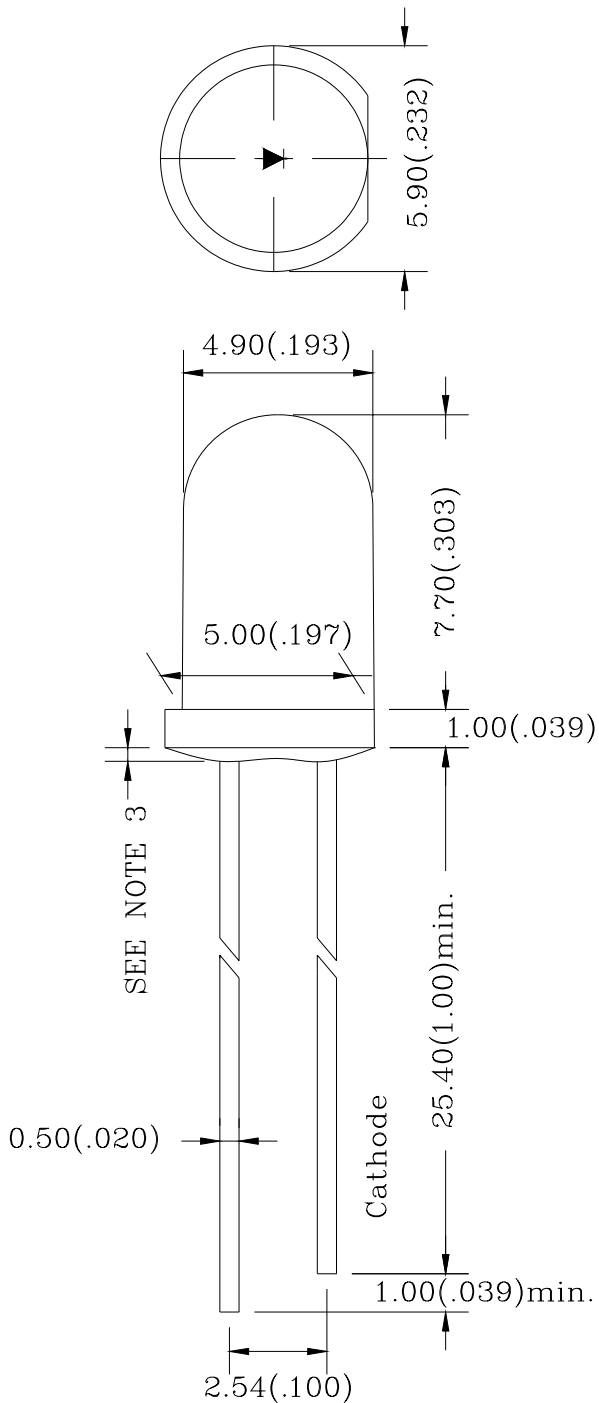

Note:

- 1.All Dimensions are in millimeters.
- 2.Tolerance is $\pm 0.25\text{mm}$ (0.010 ") Unless otherwise specified.
- 3.Protruded resin under flange is 1.5mm (0.059 ") max.
- 4.Lead spacing is measured where the leads emerge from the package.
- 5.Specification are subject to change without notice
- 6.highlight $< -400\text{V}$ the led can withstand the max static level when assembling or operation.



5.0 mm DIA LED LAMP

L-5T47UWC

REV:A / 0

FEATURES

- * SUITABLE HIGH PULSE CURRENT OPERATION
- * EXTRA HIGH RADIANT POWER AND RADIANT INTENSITY
- * HIGH RELIABILITY
- * LOW FORWARD VOLTAGE

CHIP MATERIALS

- * Dice Material : GaInN/GaN
- * Light Color : ULTRA WHITE
- * Lens Color : WATER CLEAR

ABSOLUTE MAXIMUM RATING:(Ta=25°C)

SYMBOL	DESCRIPTION	ULTRA WHITE	UNIT
PD	Power Dissipation	120	mW
VR	Reverse Voltage	5	V
IF	Average Forward Current	30	mA
-	Derating Linear From 25°C	0.4	mA/°C
Topr	Operating Temperature Range	-25°C to 85°C	
Tstg	Storage Temperature Range	-40°C to 85°C	

Lead Soldering Temperature { 1.6mm(0.063 inch) From Body } 250°C±5°C For 3 Seconds

ELECTRO-OPTICAL CHARACTERISTICS:(Ta=25°C)

SYMBOL	DESCRIPTION	TEST CONDITION	MIN.	TYP.	MAX.	UNIT
VF	Forward Voltage	IF = 20mA		3.5	4.0	V
IR	Reverse Current	VR = 5V			100	µA
2θ1/2	Half Intensity Angle	IF = 20mA	15	18	20	deg
IV	Luminous Intensity	IF = 20mA		BIN		
X	Chromaticity Coordinates	IF = 20mA		0.29		
Y		IF = 20mA		0.30		

Luminous Intensity	BIN	"MA"	IF = 20mA	5000	6000	7000	mcd
Luminous Intensity	BIN	"MB"	IF = 20mA	6200	7300	8400	mcd
Luminous Intensity	BIN	"NA"	IF = 20mA	7300	8500	9700	mcd

DRAWING NO. : DS-35-03-0377

DATE: 2004-10-18

Page: 2



5.0 mm DIA LED LAMP

L-5T47UWC

REV:A / 0

